

460 Series Hospitality TVs

32" Class LED	HG32NE460SF
40" Class LED	HG40NE460SF
43" Class LED	HG43NE460SF
50" Class LED	HG50NE460SF



SAMSUNG

A premium LED experience from the LED industry leader



460 Series Hospitality TVs

Affordable Direct-Lit LED LCD TVs

With the Samsung 460 Series Hospitality TVs, the leading LED panel manufacturer in the world allows you to deliver a premium experience to your guests, while still being budget-conscious. The 460 Series features direct-lit LED technology, to deliver all the benefits of LED, while doing it more affordably. You get big, bright, beautiful pictures, while cost of entry is similar to that of a traditional CCFL back-lit option. LED uses up to 50% less energy, too, helping you conserve and save money. Content management is made simple with the Samsung REACH 4.0 management solution. Samsung's LYNK™ DRM technology protects content, while offering guests a seamless viewing experience. It's the platform that delivers an at-home, in-room experience. And it's from Samsung.

Key features



Direct-Lit LED technology

Direct-lit LED technology provides the brilliance and energy savings advantages of LED technology, along with the uniform brightness typical of CCFL displays. And it does it all with an efficiency that makes it a more affordable technology. In fact, it's possible to upgrade your rooms to LED technology for a cost comparable to CCFL technology.



Samsung LYNK™ HD content decryption DRM

Samsung's software-based DRM technology is integrated into the entire Samsung 2016 Hotel TV line. Samsung LYNK™ offers a robust solution to unlock premium HDTV content from content providers such as cable, satellite and VOD providers, with maximum efficiency and security.



Samsung LYNK™ REACH 4.0 content management solution

Samsung's LYNK REACH 4.0 fuses the benefits of its SINC and REACH hospitality technologies to offer a comprehensive content management solution. LYNK REACH 4.0 enhances the guest experience with efficiency-enhancing technology and perks ranging from more information delivery channels to convenient communication options and efficient room management. As a unified content management solution, LYNK REACH 4.0 accommodates LAN, WIFI and coaxial infrastructures to amplify hotel management, monitoring and guest service functions. Transferred by proprietary management server (PMS) and customized templates, hospitality users can create and deliver personalized service for a more memorable experience. This includes access to a range of IP channels and RF channels, applications and services mirroring what guests expect at home and on their mobile devices. LYNK REACH 4.0 additionally enables two-way communication between hotel management and guests. The solution's efficient remote control capability for in-room display ensures quality service delivery in real time without in-room labor and maintenance.



A host of features

Features include: Home Menu, Volume Limiters, Rear Panel Lock-out, Menu Display Lock-out, Hotel Custom Logo/Welcome Message, Channel List Guide, Channel Re-mapping, Remote Jack Pack (RJP) Priority, USB Cloning and Anti-Theft Battery Cover Remote Control.

Hospitality TV sales:

1-888-727-2664 | 1-866-SAM4BIZ

samsung.com/business

samsung.com/b2bhospitalitytvs

Follow us

[youtube.com/samsungbizusa](https://www.youtube.com/samsungbizusa)

[@SamsungBizUSA](https://twitter.com/SamsungBizUSA)

Samsung 460 Series Hospitality TVs

Samsung Hospitality TVs are loaded with features that provide premier guest satisfaction, while making your job easier.

Hospitality Features

Anti-theft battery cover

Battery door is secured, ensuring batteries remain in the remote controller.

Channel remapping

Allows the hotelier to change channel and TV source to a different channel.

Clock on timer and alarm key

Allows the guest to program the TV to turn on as a wake-up alarm.

Closed captioning

A text display of all audio content, including spoken dialog and non-speech information such as the identity of the speakers and symbols for sound effects and music.

Hotel channel list

Guest master channel listing of program content. This will display content in analog or HD.

Hotel logo display with time out setting

Display hotel logo bitmap files as a greeting startup display.

Hotel mode plug & play

Interactive stand-alone mode available.

Lockout controls

The hotelier can enable rear panel and menu display lock-outs.

On screen display language

Choose English/French/Spanish.

Picture-in-picture

Display one program while another is being displayed on the full TV screen at the same time.

Power on status setting

Settings include power always on, last option or standby.

Multi-code remote

Eliminates interference when two or more TVs are used in close proximity to each other.

Samsung LYNK™ REACH 4.0 content management solution

Samsung's LYNK REACH 4.0 fuses the benefits of its SINC and REACH hospitality technologies to offer a comprehensive content management solution. LYNK REACH 4.0 enhances the guest experience with efficiency-enhancing technology and perks ranging from more information delivery channels to convenient communication options and efficient room management. As a unified content management solution, LYNK REACH 4.0 accommodates LAN, WIFI and coaxial infrastructures to amplify hotel management, monitoring and guest service functions. Transferred by proprietary management server (PMS) and customized templates, hospitality users can create and deliver personalized service for a more memorable experience. This includes access to a range of IP channels and RF channels, applications and services mirroring what guests expect at home and on their mobile devices. LYNK REACH 4.0 additionally enables two-way communication between hotel management and guests. The solution's efficient remote control capability for in-room display ensures quality service delivery in real time without in-room labor and maintenance.

Sleep timer

Allows guest to set TV turn-off time in 30-minute intervals up to 180 minutes.

USB cloning

A quick and easy way to copy the ideal settings off one television to others on the property. Saves time and helps provide a consistent viewing experience for all televisions.

Connections

Anynet + (HDMI – CEC)

This Samsung protocol allows the user to control other HDMI devices connected to the TV display, such as DVD players, PC computers and Soundbars.

ConnectShare™ (USB 2.0)

Connect a thumb drive or digital camera quickly and easily. User-friendly interface allows access to videos, a music playlist and pictures via the remote.

Remote Jack Panel (RJP) compatibility



Picture Quality and Audio

Auto volume limiter

During initial product setup, minimum and maximum volume levels can be locked to help minimize disturbance to other hotel guests.

Full HD 1080p, MPEG4

Samsung 40", 43" and 50" 460 Series TV features Full HD, while the 32" model features HD 720p. All TVs are also compatible with MPEG4.

Music mode (input: HDMI/AV/component)

Allows audio feedback when picture is muted.

Music mode backlight on/off

Shows a background display.

Direct-lit LED technology

Direct-lit LED technology provides the brilliance and energy savings advantages of LED technology, along with the uniform brightness typical of CCFL displays. And it does it all with an efficiency that makes it a more affordable technology. In fact, it is possible to upgrade your rooms to LED technology for a cost comparable to CCFL technology. When you add the energy savings of up to 50% that LED offers over CCFL, you end up with the perfect solution for both you and your guests.

Warranty

2-year parts and 2-year labor warranty backed by Samsung Hospitality Hotline 1-866-894-0524. Optional professional installation, accessories and extended warranty are available.

Samsung 460 Series Hospitality TVs



Digital Rights Management (DRM) (RF)

Samsung LYNK™ HD Content Decryption DRM



Samsung's software-based DRM technology is integrated into the entire Samsung Hotel TV line. Samsung Lynk™ offers a robust solution to unlock premium HDTV content from content providers such as cable, satellite and VOD providers, with maximum efficiency and security.

Dimensions

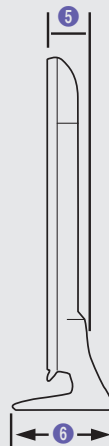
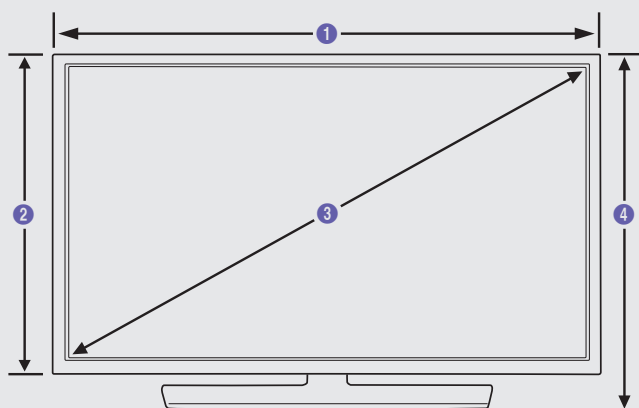

32" | HG32NE460SF - 720p

1	2	3	4	5	6
29.3"	17.4"	32.0"	19.1"	2.7"	6.4"

43" | HG43NE460SF - 1080p

1	2	3	4	5	6
38.8"	22.6"	43.0"	23.5"	2.8"	6.7"

40" | HG40NE460SF - 1080p

1	2	3	4	5	6
36.3"	20.9"	40.0"	21.7"	2.8"	6.7"

50" | HG50NE460SF - 1080p

1	2	3	4	5	6
44.9"	26.1"	50.0"	26.9"	2.9"	7.4"

Connectivity

HG32NE460SF

1. AV In
2. USB (5C 0.5A) / Cloning
3. HDMI In 1 (DVI)
4. Antenna In

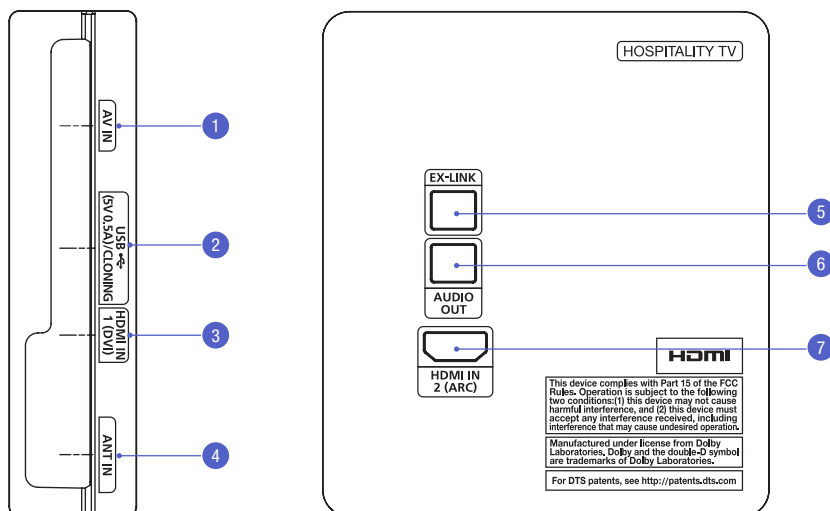

HG40NE460SF / HG43NE460SF / HG50NE460SF

1. USB (5C 0.5A) / Cloning
2. HDMI In 1 (DVI)
3. AV In (Video, Audio L/R)
4. HDMI In 2 (ARC)
5. Audio Out
6. Ex-Link
7. Antenna In (Air / Cable)

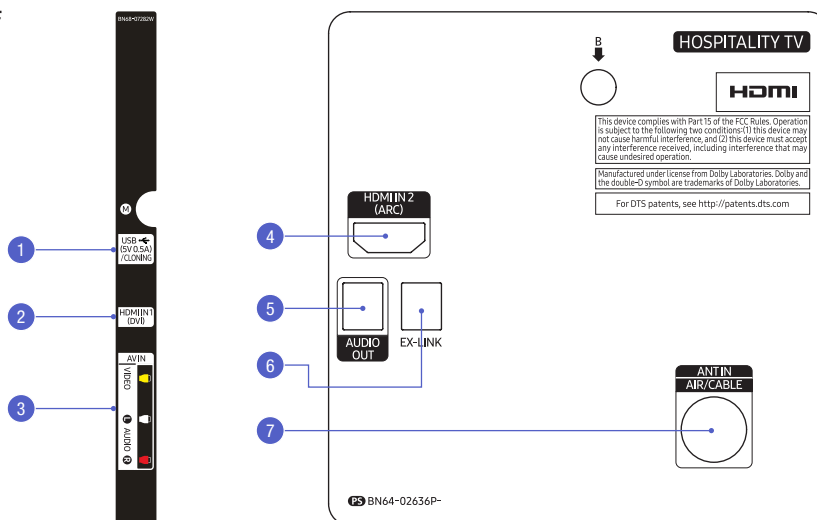

Samsung 460 Series Hospitality TVs

Samsung 460 Series Hospitality TVs Key Specifications For complete product specifications, visit samsung.com/b2bhospitalitytvs

		HG32NE460SF	HG40NE460SF	HG43NE460SF	HG50NE460SF	
Display	Backlight	LED	LED	LED	LED	
	Screen Size (Diagonal)	32"	40"	43"	50"	
	HD/FHD/UHD	HD	FHD	FHD	FHD	
	Resolution	1366 x 768	1920 x 1080	1920 x 1080	1920 x 1080	
Video	Picture Engine	HyperReal	HyperReal	HyperReal	HyperReal	
	Dynamic Contrast Ratio	Mega Contrast	Mega Contrast	Mega Contrast	Mega Contrast	
	Viewing Angle (Horizontal/Vertical)	178/178	178/178	178/178	178/178	
	Wide Color Enhancer (Plus)	Yes	Yes	Yes	Yes	
	Film Mode	Yes	Yes	Yes	Yes	
Audio	Dolby Digital Plus	Yes	Yes	Yes	Yes	
	DTS Codec	Yes	Yes	Yes	Yes	
	Sound Output (RMS)	10W (L:5W, R:5W)	20W (L:10W, R:10W)	20W (L:10W, R:10W)	20W (L:10W, R:10W)	
	Speaker Type	2CH (Down Firing w/Bass Reflex)	2CH (Down Firing w/Bass Reflex)	2CH (Down Firing w/Bass Reflex)	2CH (Down Firing w/Bass Reflex)	
Wall Mount Sound Mode	Yes	Yes	Yes	Yes		
SMART TV	Smart TV Type	Non Smart	Non Smart	Non Smart	Non Smart	
	Features					
Features	Accessibility	Voice Guide	Voice Guide	Voice Guide	Voice Guide	
	Digital Clean View	Yes	Yes	Yes	Yes	
	Auto Channel Search	Yes	Yes	Yes	Yes	
	Auto Power Off	Yes	Yes	Yes	Yes	
	Caption (Subtitle)	Yes	Yes	Yes	Yes	
	ConnectShare™ (USB 2.0)	Yes	Yes	Yes	Yes	
	Sports Mode	Yes	Yes	Yes	Yes	
	EPG	Yes	Yes	Yes	Yes	
	Game Mode	Yes	Yes	Yes	Yes	
	OSD Language	English, Spanish, French	English, Spanish, French	English, Spanish, French	English, Spanish, French	
	Picture-In-Picture	Yes	Yes	Yes	Yes	
	System	Digital Broadcasting	ATSC/Clear QAM	ATSC/Clear QAM	ATSC/Clear QAM	ATSC/Clear QAM
		Analog Tuner	Yes	Yes	Yes	Yes
Hospitality Features	Samsung LYNK™ REACH (RF)	REACH 4.0	REACH 4.0	REACH 4.0	REACH 4.0	
	Samsung LYNK™ REACH RF Modulator Compatibility	Yes	Yes	Yes	Yes	
	Hospitality Home Menu	Home Menu 2015	Home Menu 2015	Home Menu 2015	Home Menu 2015	
	Hospitality Plug&Play (Easy Setup)	Yes	Yes	Yes	Yes	
	Auto Source Mode	Yes	Yes	Yes	Yes	
	Power On Mode	Yes	Yes	Yes	Yes	
	Hotel Channel List	Yes	Yes	Yes	Yes	
	Channel Menu Display	Yes	Yes	Yes	Yes	
	Mixed Channel List (ATSC, DVB-T/T2/C/S2, Analog)	Yes	Yes	Yes	Yes	
	My Channel	Yes	Yes	Yes	Yes	
	Energy Saving Mode (BLU Control)	Yes	Yes	Yes	Yes	
	Logo Display with Timer Out Setting (BMP/Movie)	Yes	Yes	Yes	Yes	
	Welcome Message	Yes	Yes	Yes	Yes	
	Clock Back Up Power Supply	Yes	Yes	Yes	Yes	
	Software Clock	Yes	Yes	Yes	Yes	
	Multi Code Remote Control	Yes	Yes	Yes	Yes	
	Screwed Battery Cover	Yes	Yes	Yes	Yes	
	Sound Bar Compatibility	Yes	Yes	Yes	Yes	
	Music Mode (Input: PC/AV/Component/HDMI)	Yes	Yes	Yes	Yes	
	Music Mode Backlight On/Off	Yes	Yes	Yes	Yes	
Input & Output	USB Cloning	Yes	Yes	Yes	Yes	
	Smovie Compatibility	Yes	Yes	Yes	Yes	
	On/Off Timer (Schedule)	Yes	Yes	Yes	Yes	
	Wake-up Timer (Alarm)	Yes	Yes	Yes	Yes	
	Samsung LYNK™ DRM	Yes	Yes	Yes	Yes	
	Security Mode	Yes	Yes	Yes	Yes	
	S/W EPG (Solution EPG)	Yes	Yes	Yes	Yes	
	HDMI	1/1	1/1	1/1	1/1	
	USB	1/0	1/0	1/0	1/0	
	Composite In (AV)	1/0	1/0	1/0	1/0	
Design	Audio Out (Mini Jack / LR)	0/1	0/1	0/1	0/1	
	RF In (Terrestrial / Cable input / Satellite Input)	1/0	0/1	0/1	0/1	
	Ex-Link (RS232C)	Common (RJP)	Common (RJP)	Common (RJP)	Common (RJP)	
	HDMI A / Return Ch. Support	Yes	Yes	Yes	Yes	
	AnyNet+ (HDMI-CEC)	Yes	Yes	Yes	Yes	
	RJ12	N/A	N/A	N/A	N/A	
	RJP Jack (Remote Jackpack)	0/1	0/1	0/1	0/1	
	Front Color	Black	Black	Black	Black	
	Stand Type	Square	Mini Arc	Mini Arc	Mini Arc	
	Dimensions (W x H x D)	Set Size without Stand - Wall Mount Side (WxHxD) (mm/in)	745.4 x 442.2 x 57.9 / 29.3" x 17.4" x 2.3"	922.7 x 530.7 x 58.8 / 36.3" x 20.9" x 2.3"	985.5 x 575.3 x 58.8 / 38.8" x 22.6" x 2.3"	1140.8 x 662.3 x 59.9 / 44.9" x 26.1" x 2.4"
Set Size without Stand - Speaker Side (WxHxD) (mm/in)		745.4 x 442.2 x 69.0 / 29.3" x 17.4" x 2.7"	922.7 x 530.7 x 72.0 / 36.3" x 20.9" x 2.8"	985.5 x 575.3 x 72.2 / 38.8" x 22.6" x 2.8"	1140.8 x 662.3 x 72.9 / 44.9" x 26.1" x 2.9"	
Set Size with Stand (WxHxD) (mm/in)		745.4 x 484.2 x 163.4 / 29.3" x 19.1" x 6.4"	922.7 x 555.1 x 170.3 / 36.3" x 21.7" x 6.7"	985.5 x 597.1 x 170.3 / 38.8" x 23.5" x 6.7"	1140.8 x 684.2 x 187.6 / 44.9" x 26.1" x 7.4"	
Package Size (WxHxD) (mm/inch)		901.0 x 507.0 x 127.0 / 35.5" x 20.0" x 5.0"	1098.0 x 592.0 x 120.0 / 43.2" x 23.3" x 4.7"	1150.0 x 644.0 x 123.0 / 45.3" x 25.4" x 4.8"	1295.0 x 752.0 x 160.0 / 51.0" x 29.6" x 6.3"	
Weight	Set Weight without Stand (kg / lbs)	4.0 / 8.8	6.7 / 14.8	7.7 / 17.0	10.4 / 22.9	
	Set Weight with Stand (kg / lbs)	4.4 / 9.7	6.9 / 15.2	7.9 / 17.4	10.7 / 23.6	
	Package Weight (kg / lbs)	6.1 / 13.4	8.9 / 19.6	10 / 22.0	14.5 / 32.0	
Power	Power Supply (V)	AC110-120V 60Hz	AC110-120V 60Hz	AC110-120V 60Hz	AC110-120V 60Hz	
Accessory	Remote Controller Model	TM1240A	TM1240A	TM1240A	TM1240A	
	Batteries (for Remote Control)	Yes	Yes	Yes	Yes	
	Mini Wall Mount Support	Yes	Yes	Yes	Yes	
	Vesa Wall Mount Support	Yes	Yes	Yes	Yes	
	Power Cable	Yes	Yes	Yes	Yes	
	Quick Install Guide	Yes	Yes	Yes	Yes	

Learn more samsung.com/business insights.samsung.com samsung.com/b2bhospitalitytvs

Product support 1-866-SAM4BIZ

Follow us [youtube.com/samsungbizusa](https://www.youtube.com/samsungbizusa) [@SamsungBizUSA](https://twitter.com/SamsungBizUSA)

SAMSUNG